





**CL.1 Wall valve anti-clockwise closing hot 1/2" - Chrome**

CL.1

36 617 707

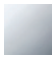

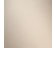
- with WAVES structure
- rosette 60 x 60 mm
- with hot marking
- head part with cut-to-length spindle and sleeve

|   |                               |               |
|---|-------------------------------|---------------|
|  | Chrome                        | 36 617 707-00 |
|  | Brushed Platinum              | 36 617 707-06 |
|  | Dark Chrome                   | 36 617 707-19 |
|  | Brushed Champagne (22kt Gold) | 36 617 707-46 |
|  | Champagne (22kt Gold)         | 36 617 707-47 |
|  | Brushed Dark Platinum         | 36 617 707-99 |

**Required miscellaneous**



- Wall valve 1/2" -** 35 607 970-90  
 •max. recess depth 150 mm 0010  
 •min. recess depth 105 mm

36 617 707

mm [inches]

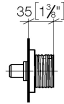
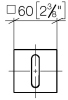

Codes & Standards

ADA

ASME  
A112.18.1/CSA  
B125.1

Certificates

DVGW\_DW-  
6501DN0116.

IAPMO\_4976 (1).

LGA\_29931.

WRAS\_2010066.

LGA\_29932.

36 617 707

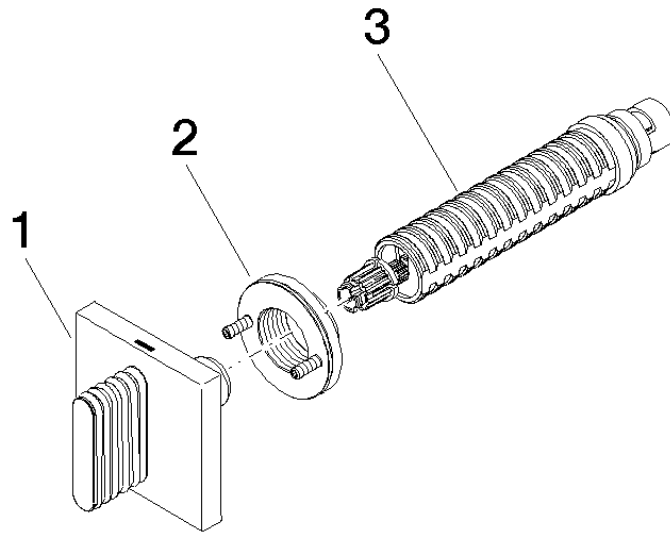

### Spare parts list

| No. | Item Number        | Name           | Quantity used | Delivery time |
|-----|--------------------|----------------|---------------|---------------|
| 1   | 90 20 70 055 03-00 | handle ( hot ) | 1             | 10            |
| 2   | 90 21 02 108 00 90 | disc           | 1             | 2             |
| 3   | 90 90 03 142 00 90 | top            | 1             | 2             |